

pH Regulator



Benefits

- **Smart pH:** predictive regulation according to the history for a perfectly stable pH
- **IPS HD panel** for optimal display quality
- **Dynamic backlit capacitive keys** for easy navigation
- **Automatic brightness adjustment** via light sensor
- **Automatic standby output** by presence sensor
- **Colour-coded display of the pool status:** blue: optimal water quality, orange: information message, red: alarm
- **Indicators of the status of the device's functions** using pictograms (OFF, STOP, INJ...)
- **Simultaneous display** of setpoints measured pH value and water temperature
- **High quality, factory tested and calibrated Black pH probe**
- **Bluetooth remote control** with e-Pool® app

Features

- **Predictive and proportional pH control based on injection history**
- **Automatic injection of correcting agent**, acid (pH-) or base (pH+)
- **Safeties:** pH setpoint overrun and overfeeding : cause of malfunction indicated by written message
- **Log of events**
- **Multilingual communication interface**
- **Easy installation and assembly**

pH Regulator

Model	Pool volume (m ³)	Pump flow (l/h)	Reference
Poolsquad pH	160	1,8	REGU23NPSP-G5

Technical specification

Display	IPS HD panel
Screen size	4,3 inches
Keyboard type	capacitive keys
Presence sensor range (cm)	20
Corrective solution	pH- or pH+
pH regulation type	predictive
pH pump type	peristaltic
Setpoint adjustment	6,8 to 7,6
pH probe calibration	2 points pH 7 and pH 10
pH probe	Black
Control panel size (mm)	W 140 x H 300 x D 97

Installation Diagram

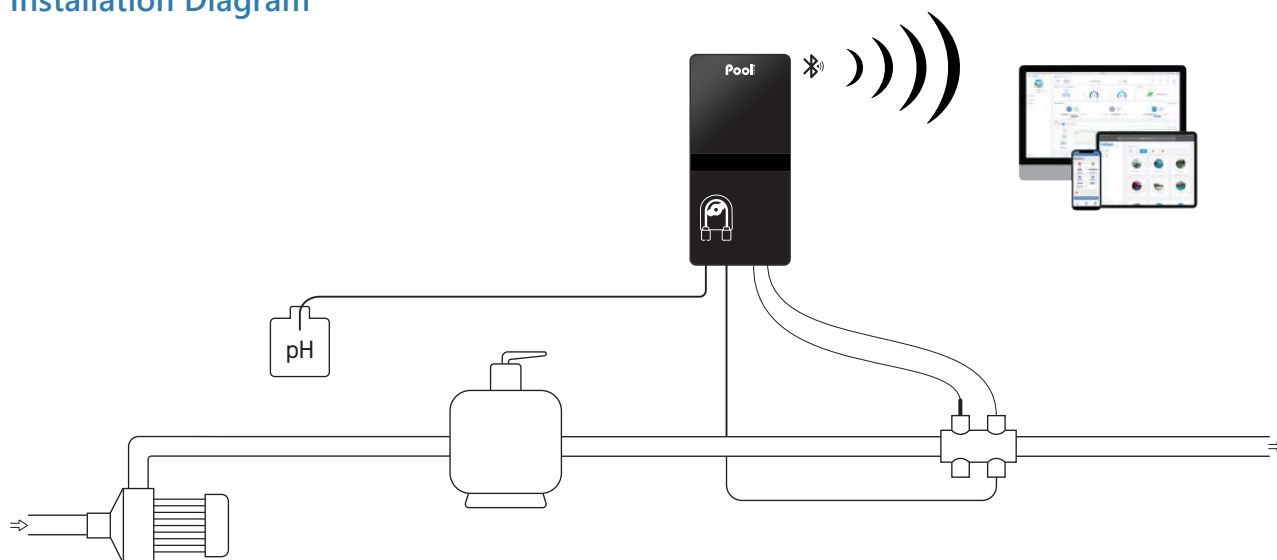

Warranties

2 years	Box
-------------------	-----

3 years	Probe pH Black
-------------------	-------------------